



HOLLIS INNOVATION ACADEMY

PROJECT COMMITTEE MEETING #1

SEPTEMBER 7, 2017

You have to know your own worth

— Michael R. Hollis, Air Atlanta founder



HABITS OF
HOLLIS

compassion
empathy
communication
self-discipline
creativity
perseverance

Let's focus on
designing a
school that
supports a
love of teaching
and a
passion to learn.

curriculum
instructional leadership
STEM integration
teacher-self efficacy
teacher leadership
urban education
adult learning theory
professional development
strategic planning
student performance

— Dr. Diamond M. Jack

Expeditionary Learning (EL) Curriculum & Innovative STEM-focused Curriculum





**65% OF TODAY'S GRADE
SCHOOL KIDS WILL END UP AT
JOBS THAT HAVEN'T BEEN
INVENTED YET.**

- Center for Evaluation & Education Policy, Indiana University



HOLLIS INNOVATION ACADEMY

Existing Photos - STEM





HOLLIS INNOVATION ACADEMY

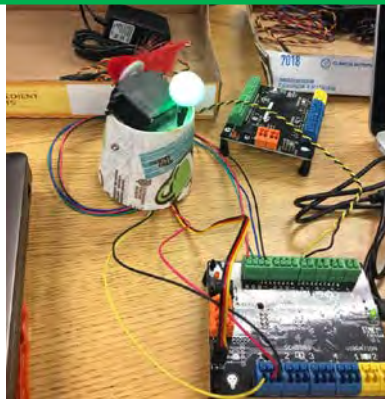



HOLLIS INNOVATION ACADEMY

Existing Site





HOLLIS INNOVATION ACADEMY

Existing Photos – James P Brawley Dr

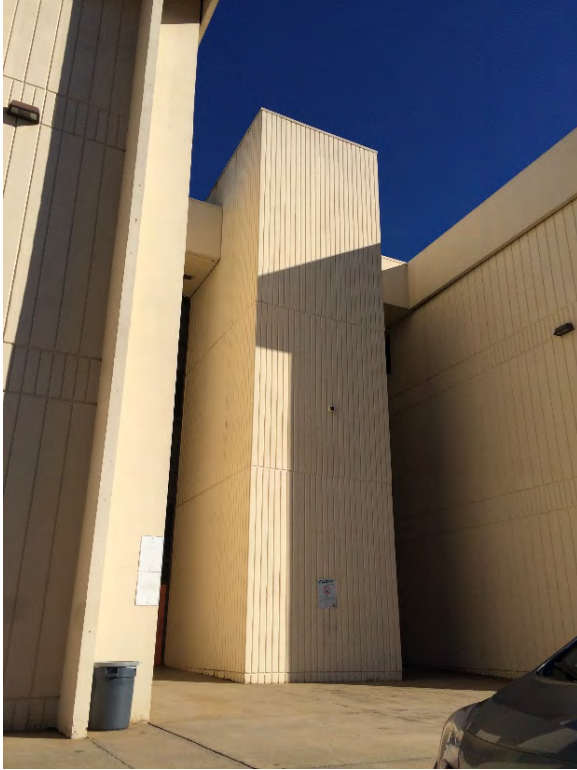



HOLLIS INNOVATION ACADEMY

Existing Photos – Griffin St





HOLLIS INNOVATION ACADEMY

Existing Photos – Interior Courtyards





HOLLIS INNOVATION ACADEMY

Existing Photos - Pool





Project Overview



- Grades: Pre K – 8
- Site Size: 5.0 acres
- Organization History: Multiple buildings. Constructed 1963 - 1970
- Status: Last renovated 2004
- Core Classrooms: +/- 41 (existing)
- Student Capacity: +/- 1,025 @ 25 students per classroom (current)
- Core Classrooms: +/- 41 (proposed)
- Student Capacity: +/- 1,025 @ 25 students per classroom (proposed)
- Approximate Size: +/- 228,355 sf (existing)
- Tentative Schedule: Phased June 2018 – June 2020



Project Outline



ATLANTA
PUBLIC
SCHOOLS

- Select improvements to support K-8 instructional needs
- New and additional windows
- Improved street identity
- Roof and envelope upgrades
- Door, window and hardware upgrades
- Renovated pool, pool equipment and pool structure
- Electrical, HVAC and plumbing upgrades
- Exterior and interior finish upgrades
- Data, voice, video upgrades
- Life Safety systems upgrades
- Interior and exterior signage upgrades
- CCTV, security and access control upgrades
- Furniture and casework upgrades
- Site upgrades
- Improved security and access to Main Office
- Updated HVAC, electrical and plumbing systems
- Updated low voltage, data, voice, video, life safety and security systems
- Improved landscape and hardscape



BLDG. 4011
1970
10,486 SF

BLDG. 4010
1983
80,939 SF

Rooms and Areas:

- READING AREA N-123 290 SF
- OFFICE SPACE N-125 3342 SF
- HEALTH ROOM N-121 843 SF
- STORAGE N-125
- STORAGE N-131
- CLINIC S-109 512 SF
- SRT 1 ED. S-101 990 SF
- OPERATIONS S-104 563 SF
- STO. S-105
- STO. S-106
- SRT 1 MAINT. STORAGE S-111 1444 SF
- STO. S-110
- STO. S-112
- STO. S-113
- STO. S-114
- STO. S-115
- STO. S-116
- STO. S-117
- STO. S-118
- STO. S-119
- STO. S-120
- STO. S-121
- STO. S-122
- STO. S-123
- STO. S-124
- STO. S-125
- STO. S-126
- STO. S-127
- STO. S-128
- STO. S-129
- STO. S-130
- STO. S-131
- STO. S-132
- STO. S-133
- STO. S-134
- STO. S-135
- STO. S-136
- STO. S-137
- STO. S-138
- STO. S-139
- STO. S-140
- STO. S-141
- STO. S-142
- STO. S-143
- STO. S-144
- STO. S-145
- STO. S-146
- STO. S-147
- STO. S-148
- STO. S-149
- STO. S-150
- STO. S-151
- STO. S-152
- STO. S-153
- STO. S-154
- STO. S-155
- STO. S-156
- STO. S-157
- STO. S-158
- STO. S-159
- STO. S-160
- STO. S-161
- STO. S-162
- STO. S-163
- STO. S-164
- STO. S-165
- STO. S-166
- STO. S-167
- STO. S-168
- STO. S-169
- STO. S-170
- STO. S-171
- STO. S-172
- STO. S-173
- STO. S-174
- STO. S-175
- STO. S-176
- STO. S-177
- STO. S-178
- STO. S-179
- STO. S-180
- STO. S-181
- STO. S-182
- STO. S-183
- STO. S-184
- STO. S-185
- STO. S-186
- STO. S-187
- STO. S-188
- STO. S-189
- STO. S-190
- STO. S-191
- STO. S-192
- STO. S-193
- STO. S-194
- STO. S-195
- STO. S-196
- STO. S-197
- STO. S-198
- STO. S-199
- STO. S-200

Other Labels:

- POOL DECK N-101 10048 SF
- SWIMMING POOL N-107
- MECH. RM. N-105
- MECH. SPACE N-100
- BOYS DRESSING ROOM N-138 1839 SF
- GIRLS DRESSING ROOM N-139 2212 SF
- BOYS LOCKER ROOM N-109 1404 SF
- WOMEN'S LOCKER ROOM N-110 1167 SF
- STORAGE N-115
- STORAGE N-116
- STORAGE N-117
- STORAGE N-118
- STORAGE N-119
- STORAGE N-120
- STORAGE N-121
- STORAGE N-122
- STORAGE N-123
- STORAGE N-124
- STORAGE N-125
- STORAGE N-126
- STORAGE N-127
- STORAGE N-128
- STORAGE N-129
- STORAGE N-130
- STORAGE N-131
- STORAGE N-132
- STORAGE N-133
- STORAGE N-134
- STORAGE N-135
- STORAGE N-136
- STORAGE N-137
- STORAGE N-138
- STORAGE N-139
- STORAGE N-140
- STORAGE N-141
- STORAGE N-142
- STORAGE N-143
- STORAGE N-144
- STORAGE N-145
- STORAGE N-146
- STORAGE N-147
- STORAGE N-148
- STORAGE N-149
- STORAGE N-150
- STORAGE N-151
- STORAGE N-152
- STORAGE N-153
- STORAGE N-154
- STORAGE N-155
- STORAGE N-156
- STORAGE N-157
- STORAGE N-158
- STORAGE N-159
- STORAGE N-160
- STORAGE N-161
- STORAGE N-162
- STORAGE N-163
- STORAGE N-164
- STORAGE N-165
- STORAGE N-166
- STORAGE N-167
- STORAGE N-168
- STORAGE N-169
- STORAGE N-170
- STORAGE N-171
- STORAGE N-172
- STORAGE N-173
- STORAGE N-174
- STORAGE N-175
- STORAGE N-176
- STORAGE N-177
- STORAGE N-178
- STORAGE N-179
- STORAGE N-180
- STORAGE N-181
- STORAGE N-182
- STORAGE N-183
- STORAGE N-184
- STORAGE N-185
- STORAGE N-186
- STORAGE N-187
- STORAGE N-188
- STORAGE N-189
- STORAGE N-190
- STORAGE N-191
- STORAGE N-192
- STORAGE N-193
- STORAGE N-194
- STORAGE N-195
- STORAGE N-196
- STORAGE N-197
- STORAGE N-198
- STORAGE N-199
- STORAGE N-200

Dimensions:

- 63'-11"
- 65'-7"
- 61'-0"
- 152'-5"
- 398'-0"



HOLLIS INNOVATION ACADEMY

Existing Floor Plan – Level 02

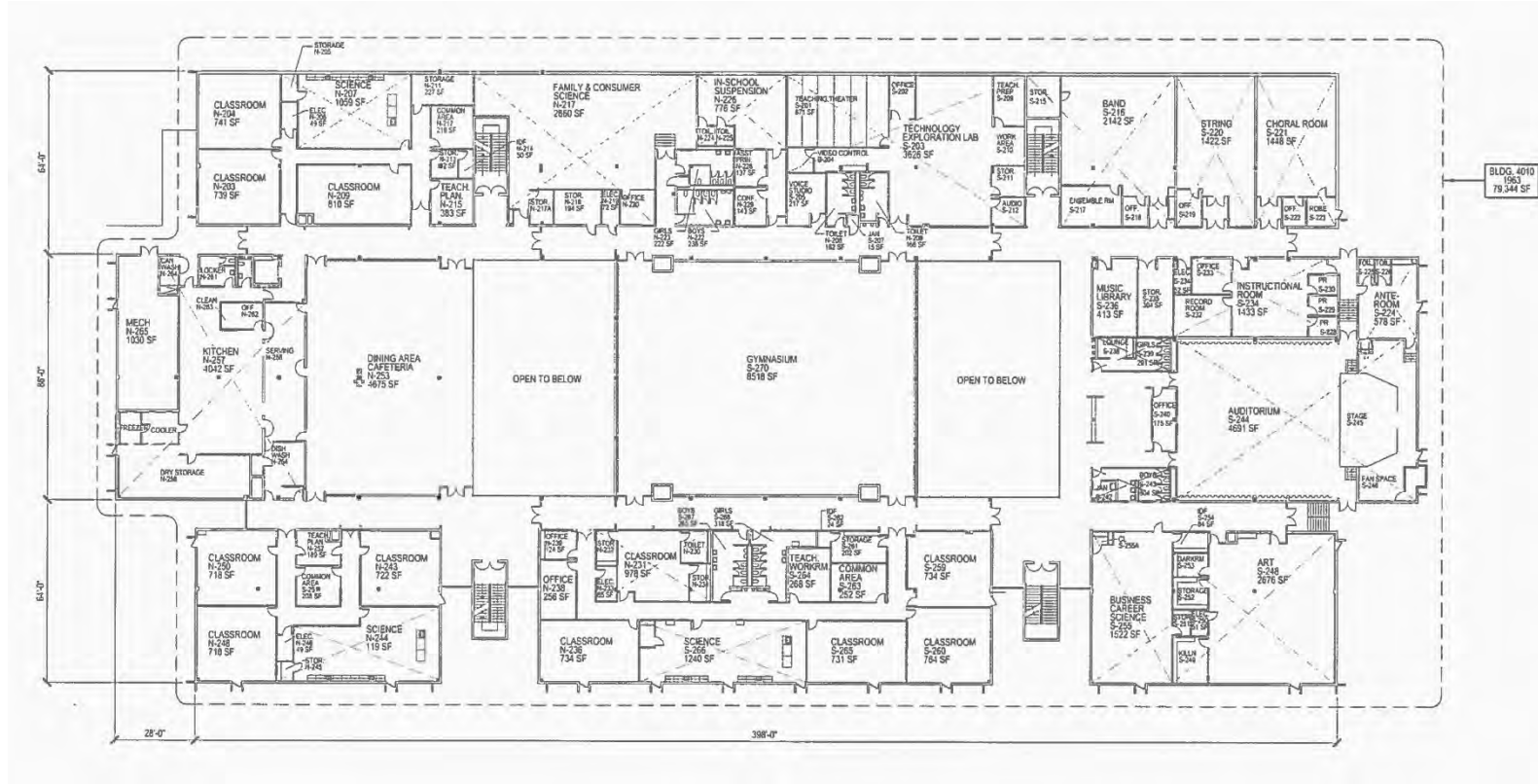

[illegible]



HOLLIS INNOVATION ACADEMY

New Site Plan





HOLLIS INNOVATION ACADEMY

New Floor Plan – Level 01

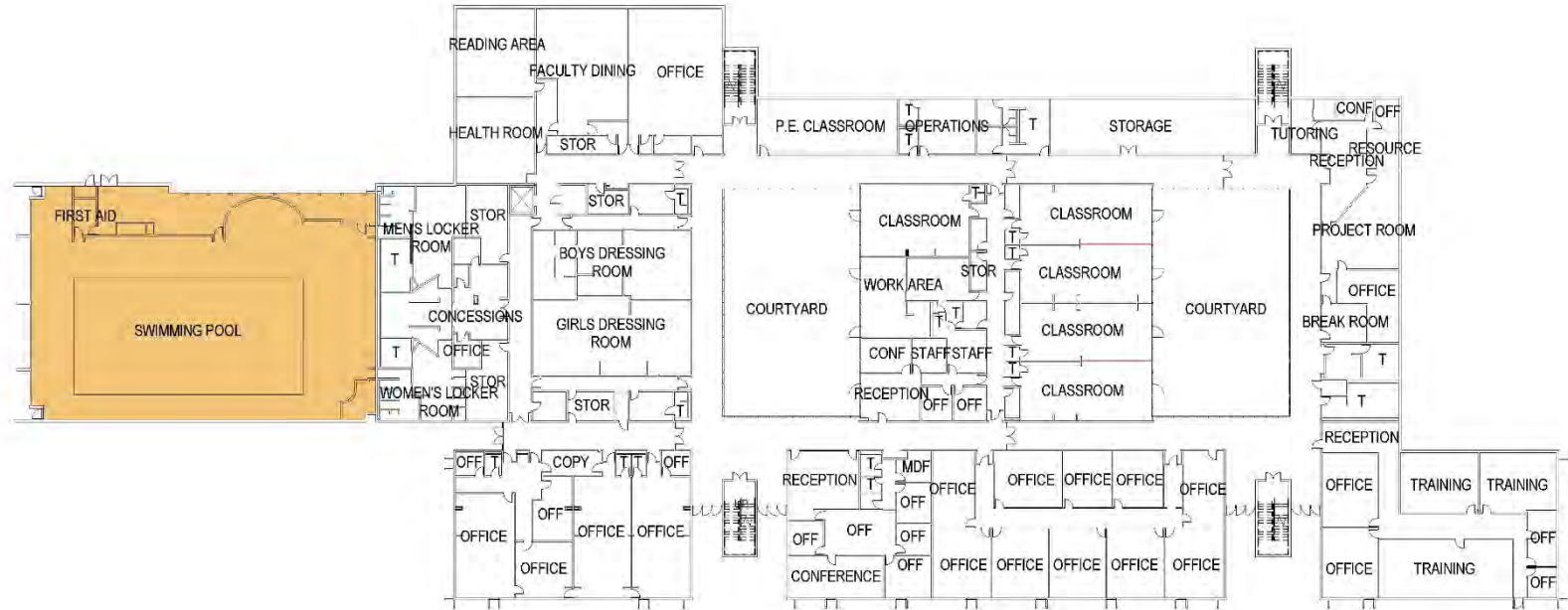

SCALE 1/32"=1'





HOLLIS INNOVATION ACADEMY

New Floor Plan – Level 02

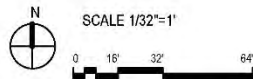



HOLLIS INNOVATION ACADEMY

New Floor Plan – Level 03

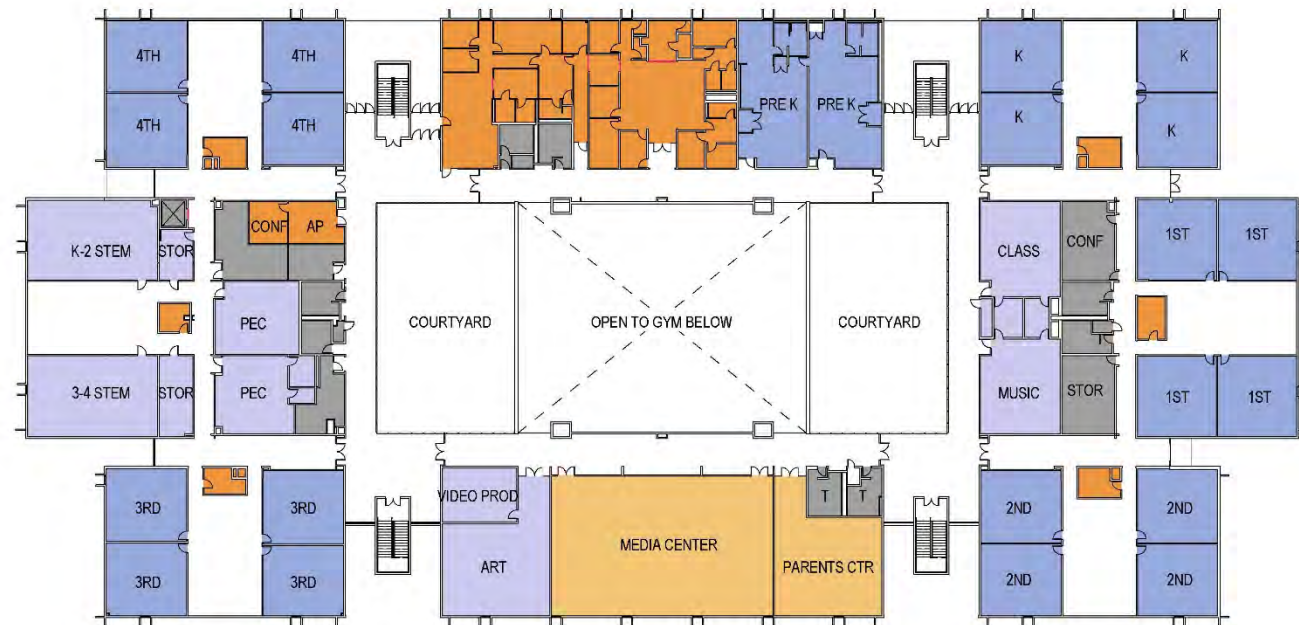

SCALE 1/32"=1'

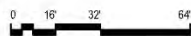



HOLLIS INNOVATION ACADEMY





HOLLIS INNOVATION ACADEMY





HOLLIS INNOVATION ACADEMY

New West Elevation





HOLLIS INNOVATION ACADEMY

New West Elevation





HOLLIS INNOVATION ACADEMY

New East Elevation



Q & A
THANK YOU